

ORDINANCE NO.
ADOPTION OF THE TOWN OF PLATTEVILLE ZONING MAP
 Introduced, Passed and Adopted at a Regular Meeting of the Board of Trustees of the Town of Platteville After a Public Hearing and Signed on the ___ day of ___, 20__

BY: _____ Mayor

ATTEST: _____ Town Clerk

SEAL

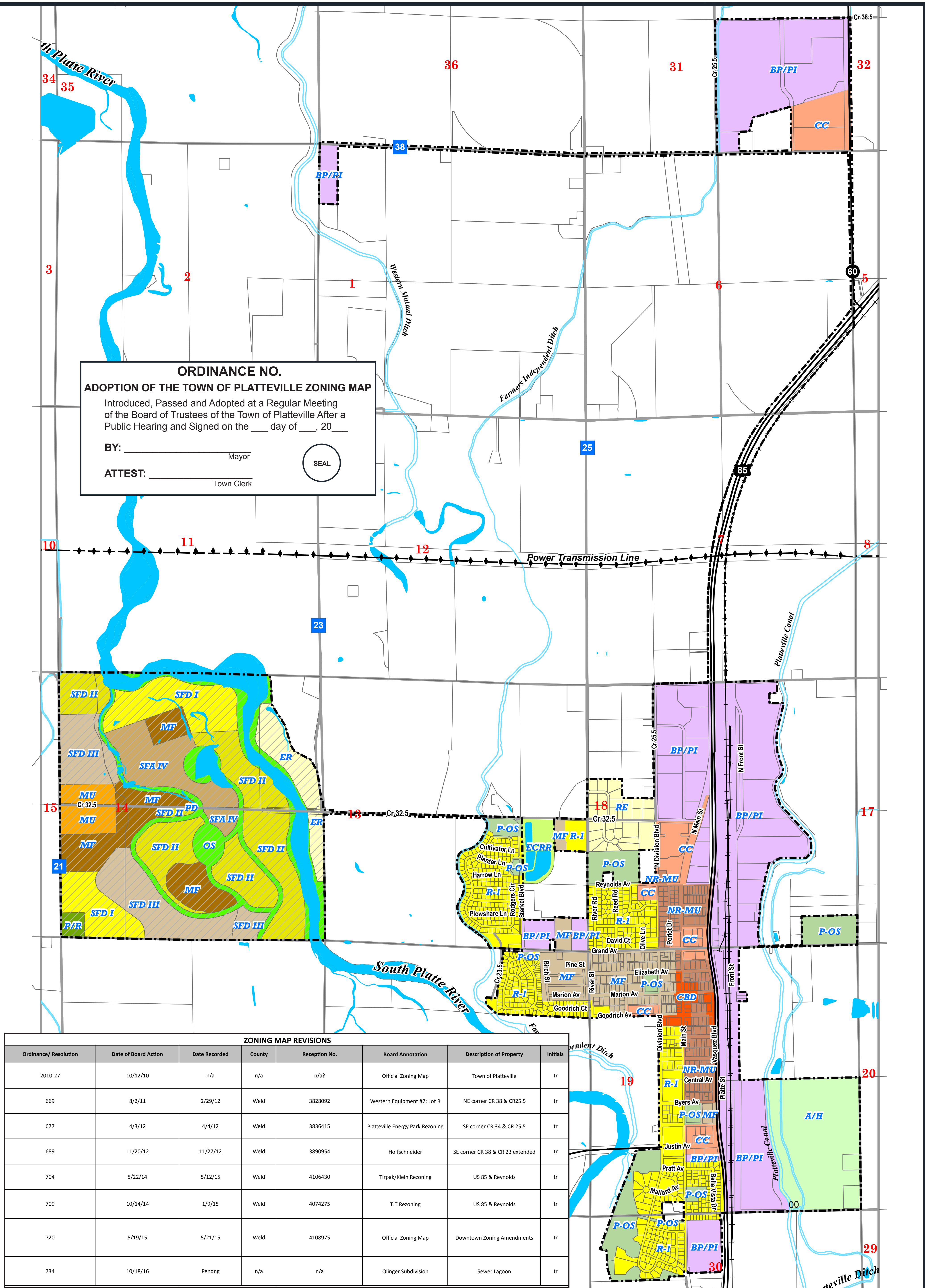

ZONING MAP REVISIONS							
Ordinance/ Resolution	Date of Board Action	Date Recorded	County	Reception No.	Board Annotation	Description of Property	Initials
2010-27	10/12/10	n/a	n/a	n/a?	Official Zoning Map	Town of Platteville	tr
669	8/2/11	2/29/12	Weld	3828092	Western Equipment #7: Lot B	NE corner CR 38 & CR25.5	tr
677	4/3/12	4/4/12	Weld	3836415	Platteville Energy Park Rezoning	SE corner CR 34 & CR 25.5	tr
689	11/20/12	11/27/12	Weld	3890954	Hoffschneider	SE corner CR 38 & CR 23 extended	tr
704	5/22/14	5/12/15	Weld	4106430	Tirpak/Klein Rezoning	US 85 & Reynolds	tr
709	10/14/14	1/9/15	Weld	4074275	TJT Rezoning	US 85 & Reynolds	tr
720	5/19/15	5/21/15	Weld	4108975	Official Zoning Map	Downtown Zoning Amendments	tr
734	10/18/16	Pending	n/a	n/a	Olinger Subdivision	Sewer Lagoon	tr

- Zoning Districts**
- RE** Residential Estate District
 - R-I** Low Density Residential District
 - MF** Multi-Family Residential District
 - CC** Community Commercial District
 - NR-MU** Neighborhood Residential-Mixed Use District
 - CBD** Central Business District
 - RC** Regional Commercial District
 - PD** Planned Development District
 - BP/PI** Business Park/Planned Industrial District
 - SO** Small Office/Warehouse District
 - P-OS** Parks/Open Space District
 - ECRR** Environmentally Constrained Residential/Recreation District
 - A/H** Agricultural/Holding

- West Farm Planned Development Zone Districts**
- ER** Estate Residential
 - SFD-I** Single Family Detached I
 - SFD-II** Single Family Detached II
 - SFD-III** Single Family Detached III
 - SFA-IV** Single Family Attached IV
 - MF** Multi-Family
 - MU** Mixed Use
 - OS** Open Space

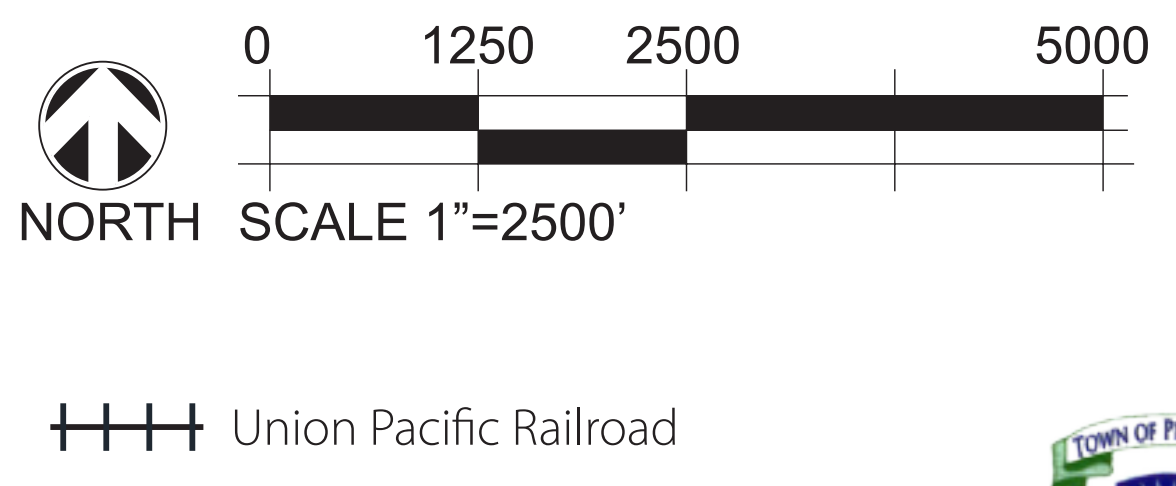

Official Zoning Map

